

BALLY REFRIGERATION PARTS AND ACCESSORIES

BALLY REFRIGERATION

(VIEW FROM STRAIGHT ON)

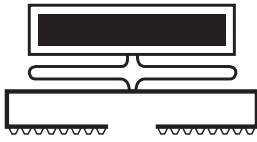

018610 BALLY REFRIGERATION GASKET FRAME

- 35 1/2" x 78 1/2"
- 3 sided

(VIEW FROM STRAIGHT ON)



BALLY REFRIGERATION GASKET FRAMES

- 016545**
• 35 5/8" x 75 3/4"
- 016546**
• 35 5/8" x 77 3/4"

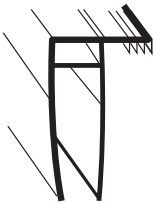

016611/016688 BALLY REFRIGERATION DOOR SWEEP

- 36" in length
- Replaces old style sweep



BALLY REFRIGERATION LEVER HANDLE AND STRIKE WITH INSIDE RELEASE

- 016622** Lever handle, strike, and inside release handle only
- 018707** Inside release rod only
- Flush mount
- Inside release for walls up to 4" thick

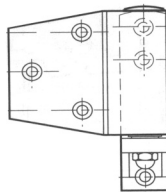
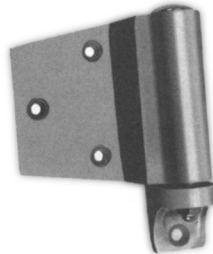

016571 BALLY REFRIGERATION CAM LIFT HINGE

- Flush mount



016768 BALLY REFRIGERATION HEAVY DUTY HYDRAULIC DOOR CLOSER

- Flush mount

NOTE: Also Kason 1094

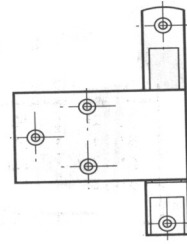
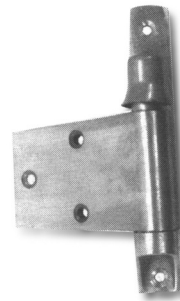

BALLY REFRIGERATION HINGES

- Flush mount
- Spring assisted
- 5 1/8" overall length
- 3" blade width

- 017786** For left hand doors
- 017783** For right hand doors



BALLY REFRIGERATION 017000 STEM TYPE DIAL THERMOMETER

- 2" dial, 6" stem
- -40° to 60° F

